

HYSPEC Instrument: Status and Performance

M. Hagen

**Neutron Facilities Development Division,
SNS, Oak Ridge National Lab.**

W.J. Leonhardt and A. Ruga

**Condensed Matter Physics & Materials Science,
Brookhaven National Lab.**

SING



Instrument Performance by Phase

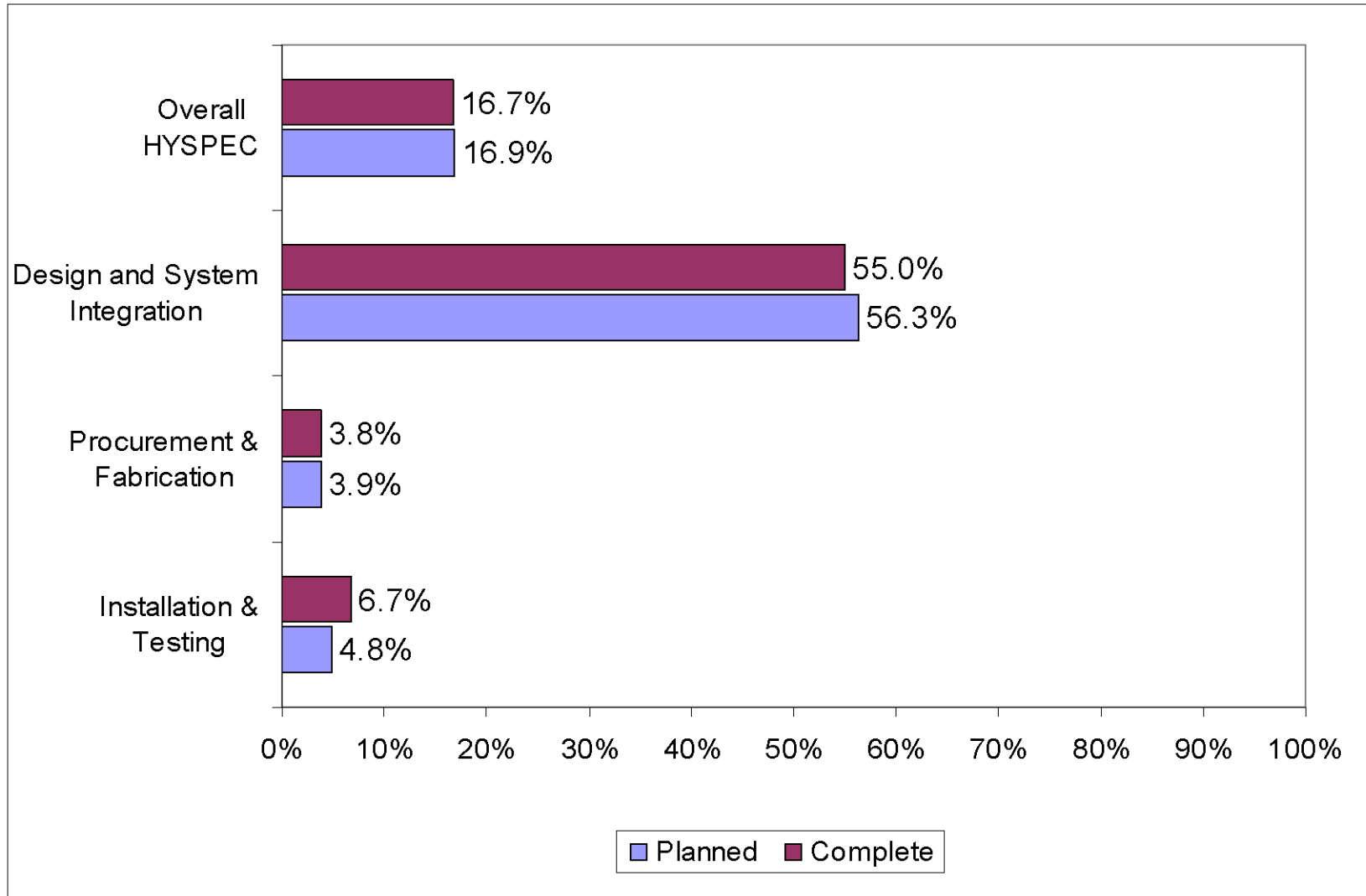

Overview

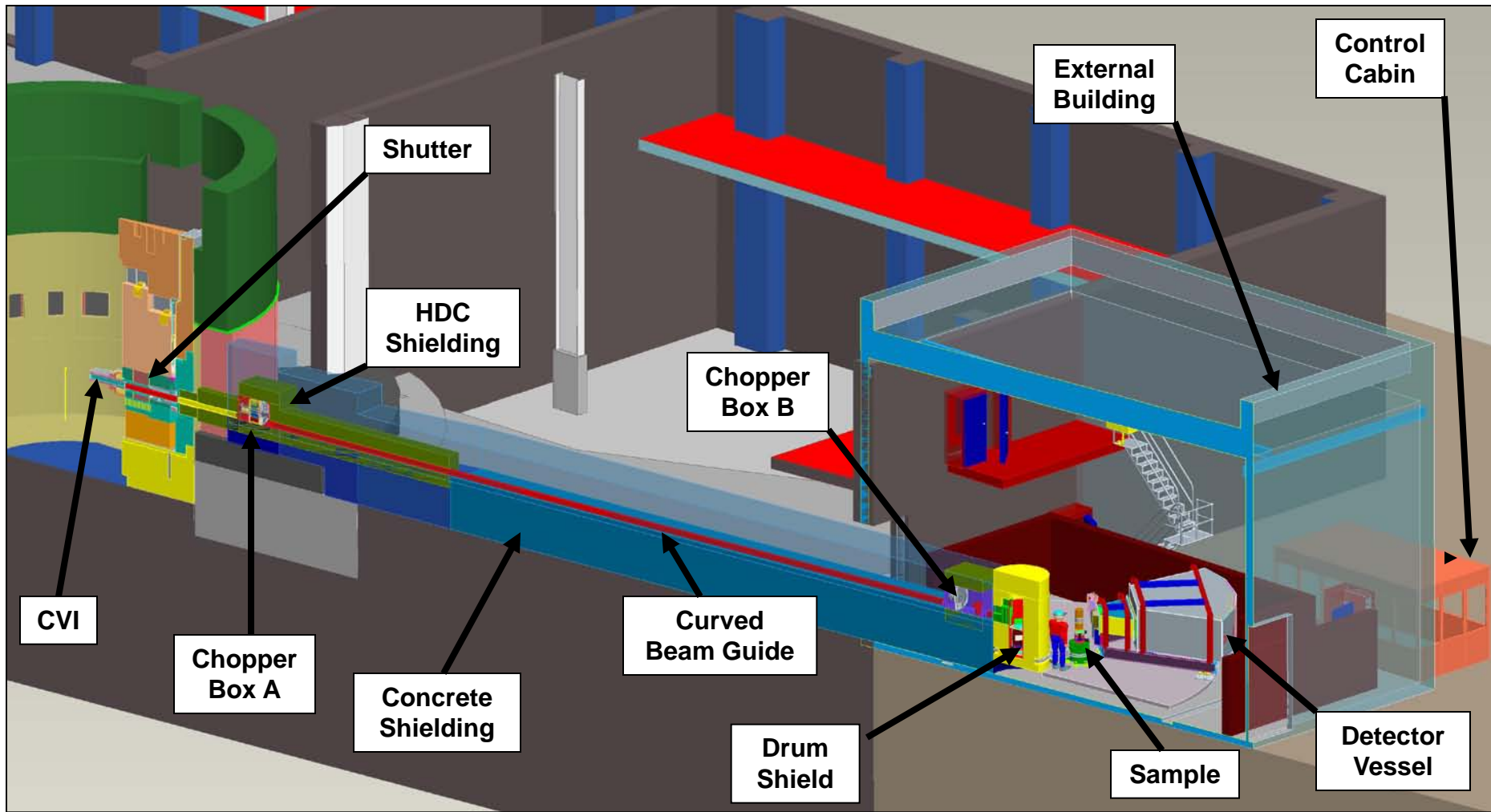

External building

Share common foundation slab with BL13 (FnPB)

Year 1 – Foundation slab + HYSPEC building

Year 2 – FnPB building

HYSPEC specifications are done.

FnPB specifications are almost done.

A&E bids in July/August.

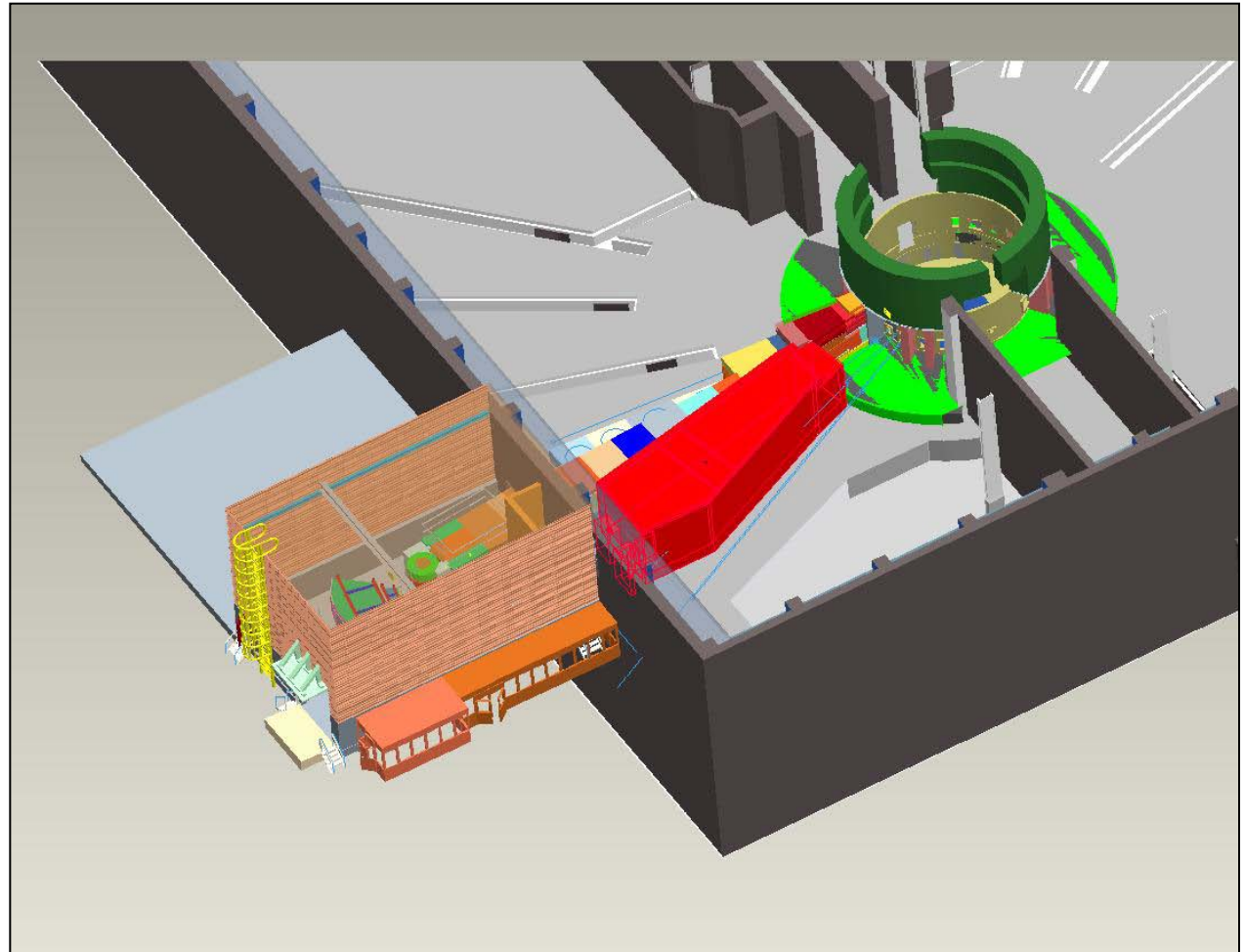

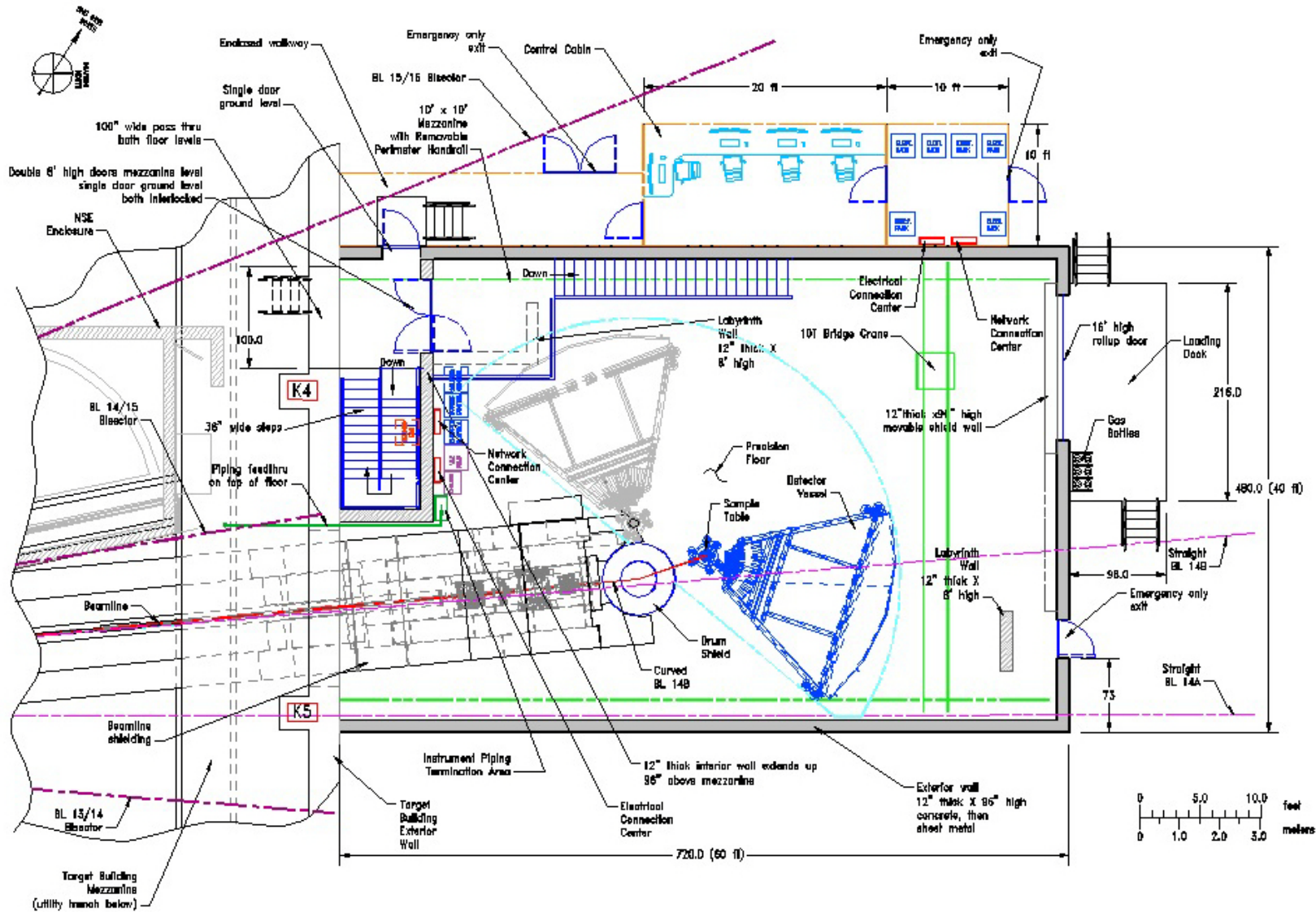

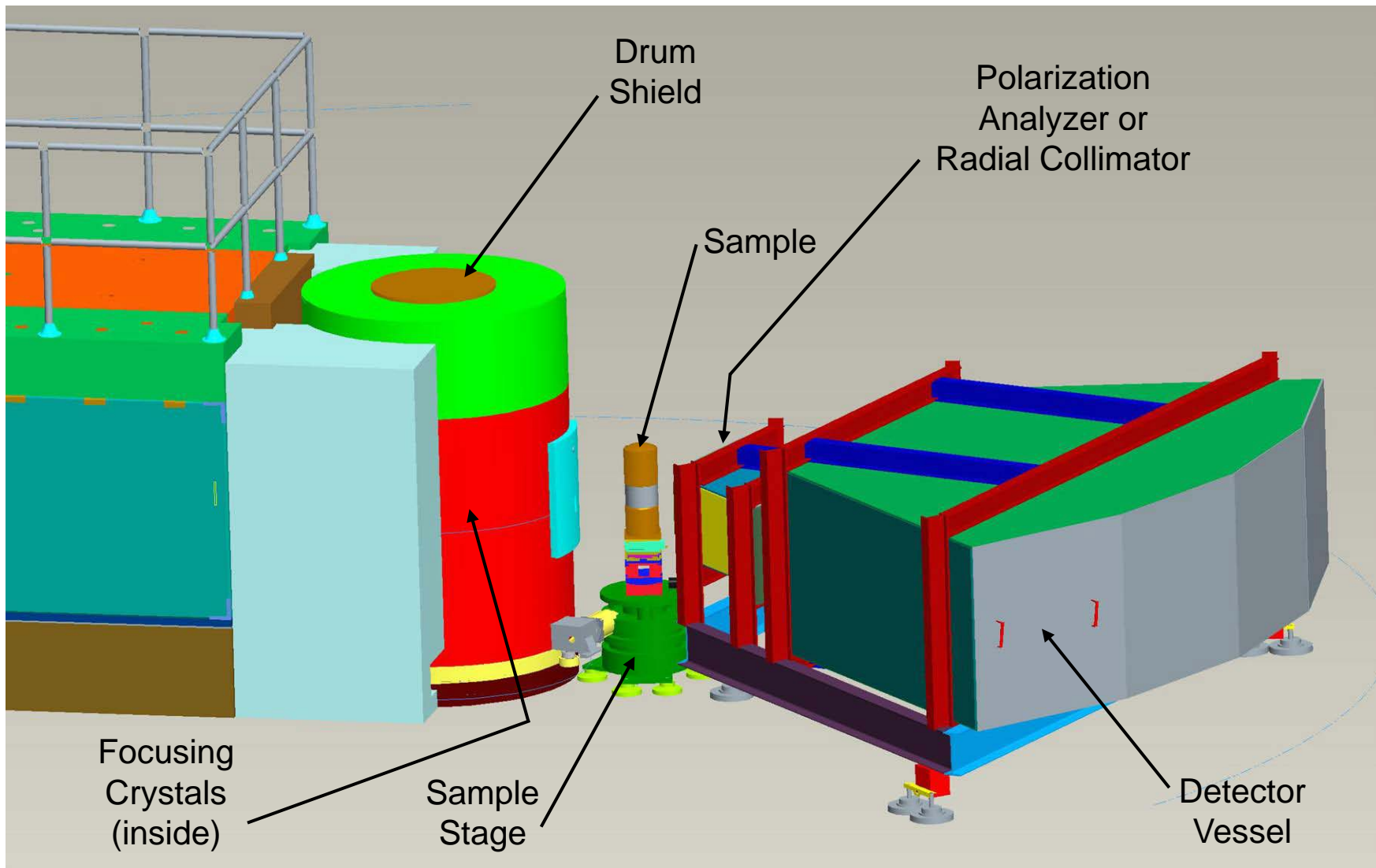



Polarizing (Heusler)

Ordered 33 crystals from ILL
First 11 in December 2008
Second 11 in June 2009
Final 11 in December 2009

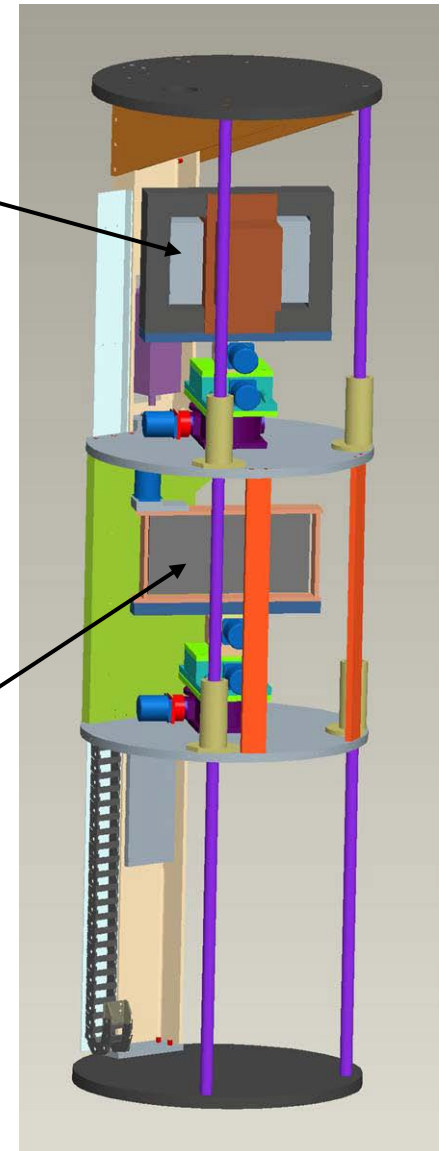

Non-polarizing

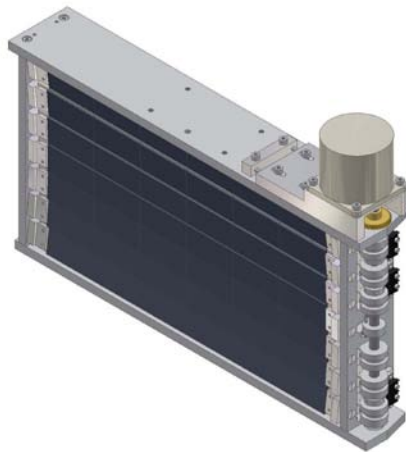

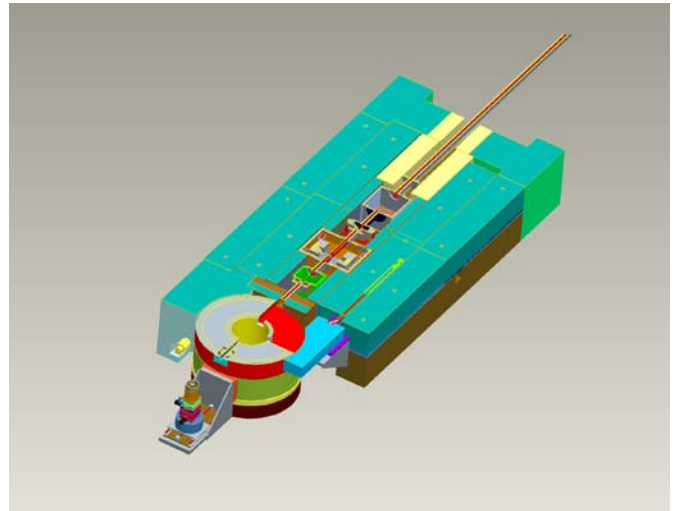
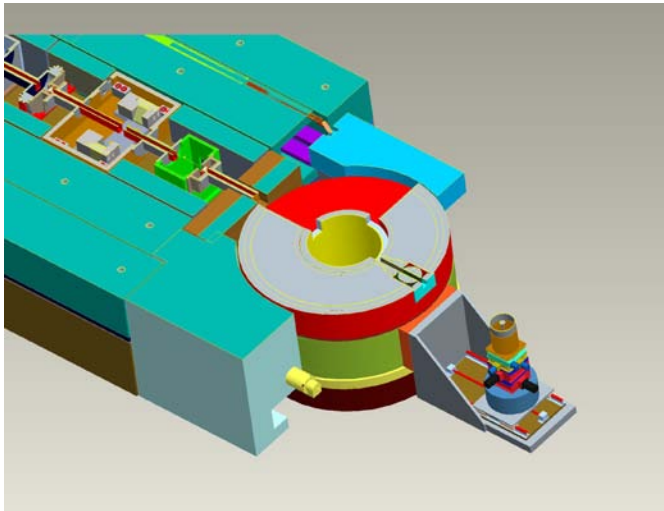
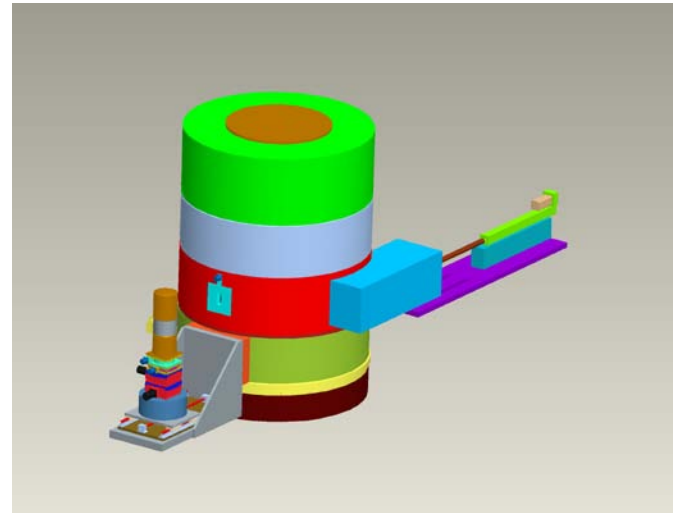
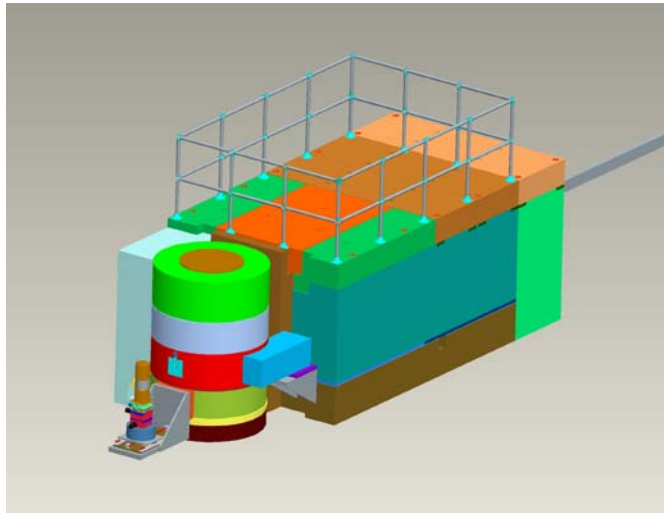

IDT Executive Committee Meeting

2nd April 2007, CNMS, ORNL

Peter Allenspach (PSI), Rob McQueeney (Ames/Iowa), Jim Rhyne (LANL),
Steve Shapiro (BNL), Igor Zaliznyak (BNL)

SING

Schedule

Engineering design

Buildings

Procurements

Polarization – mirrors & ^3He



Summary

- Design is continuing
 - Completed = primary beamline (choppers, guides, shielding)
 - Current = drum shield system
 - Future = sample stage, detector vessel, ^3He polarization analyzer
- Procurements = CVI, BSI, T0 chopper, Heusler crystals, (A&E drawings for building)
- Installed = CVI, BSI, 6-15m poured in place