

c:\2020\BNLab\20-01 EPD\Task 08 2020 Annual GW Report\Figures\Cadd\Fig\_3-02-03-01\_061421.dwg

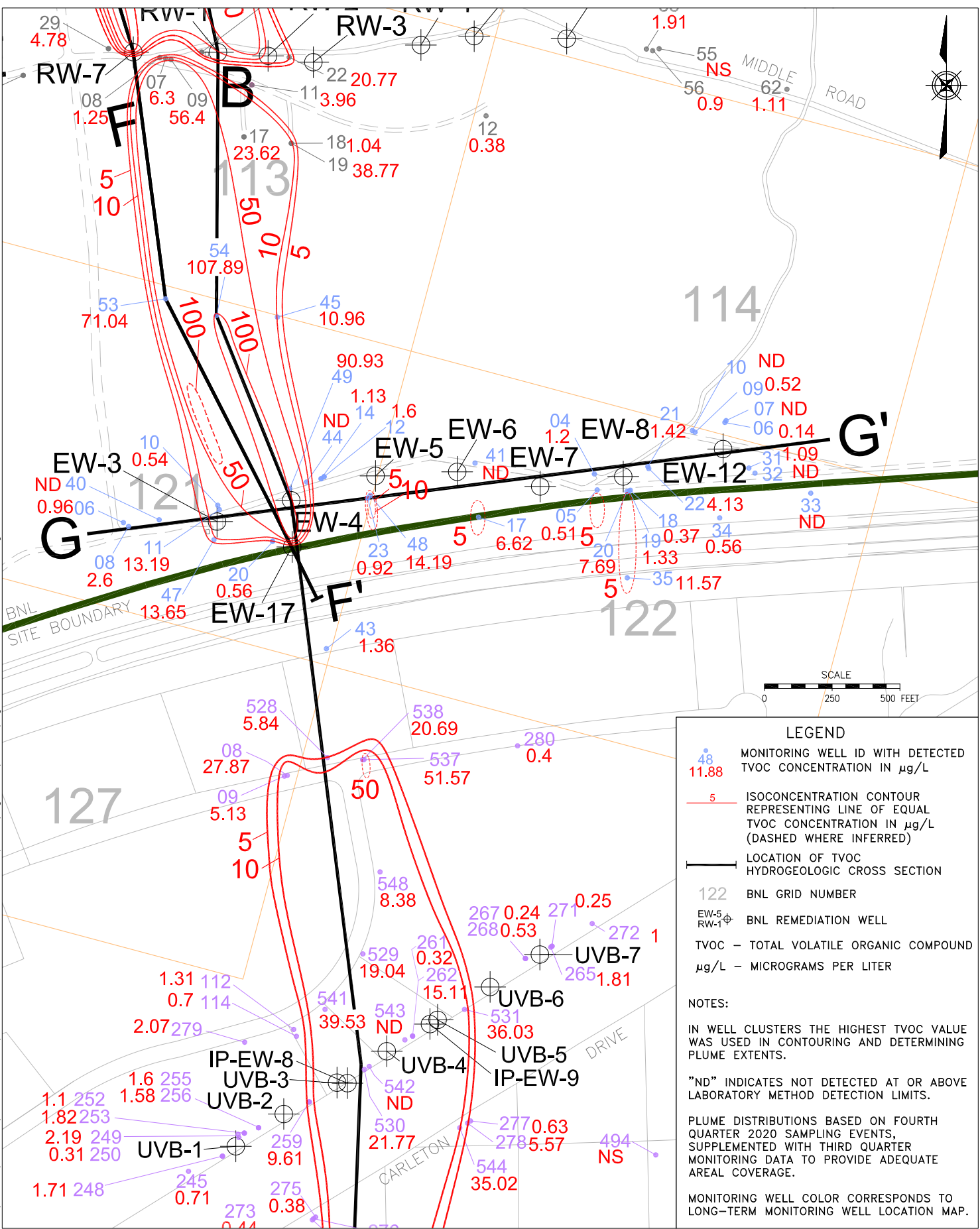

**LEGEND**

- 48  
11.88 MONITORING WELL ID WITH DETECTED TVOC CONCENTRATION IN µg/L
- 5 ISOCONCENTRATION CONTOUR REPRESENTING LINE OF EQUAL TVOC CONCENTRATION IN µg/L (DASHED WHERE INFERRED)
- LOCATION OF TVOC HYDROGEOLOGIC CROSS SECTION
- 122 BNL GRID NUMBER
- EW-5  $\phi$   
RW-1  $\phi$  BNL REMEDIATION WELL
- TVOC - TOTAL VOLATILE ORGANIC COMPOUND  
µg/L - MICROGRAMS PER LITER

**NOTES:**

IN WELL CLUSTERS THE HIGHEST TVOC VALUE WAS USED IN CONTOURING AND DETERMINING PLUME EXTENTS.

"ND" INDICATES NOT DETECTED AT OR ABOVE LABORATORY METHOD DETECTION LIMITS.

PLUME DISTRIBUTIONS BASED ON FOURTH QUARTER 2020 SAMPLING EVENTS, SUPPLEMENTED WITH THIRD QUARTER MONITORING DATA TO PROVIDE ADEQUATE AREAL COVERAGE.

MONITORING WELL COLOR CORRESPONDS TO LONG-TERM MONITORING WELL LOCATION MAP.



TITLE:  
**OU III AND OU IV SOUTH BOUNDARY/  
 INDUSTRIAL PARK AREAS,  
 TVOC PLUME DISTRIBUTION**  
 2020 BNL GROUNDWATER STATUS REPORT

DWN: AJZ	VT:HZ.: -	DATE: 03/26/21	PROJECT NO.: -
CHKD: WRD	APPD: WRD	REV.: 06/14/21	NOTES: -

FIGURE NO.: **3.2.3-1**