

P:\2016\BNLab\16-02 Environmental Protection Division\Task 09 2017 Annual GW Report\Report\2018-06-15\ACAD Figures\Fig\_3-01-05\_061518.dwg

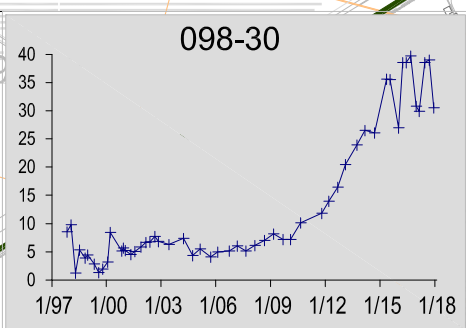
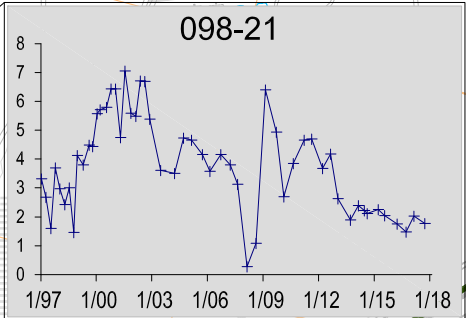
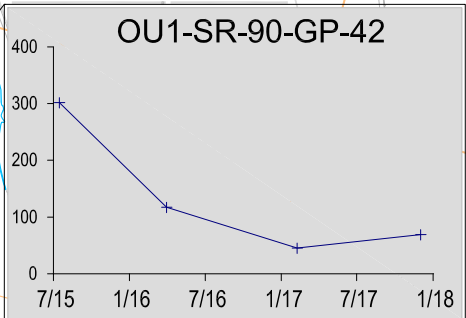
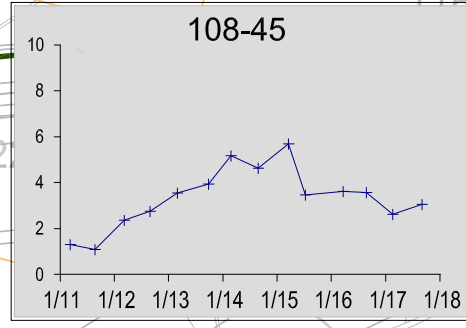
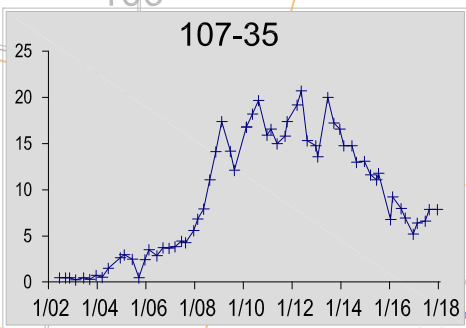
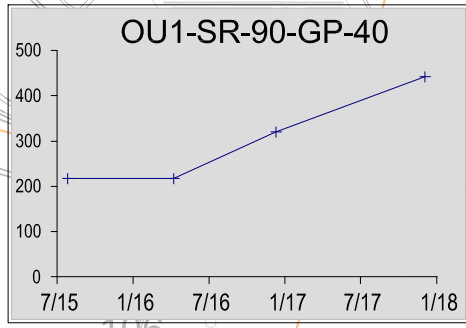
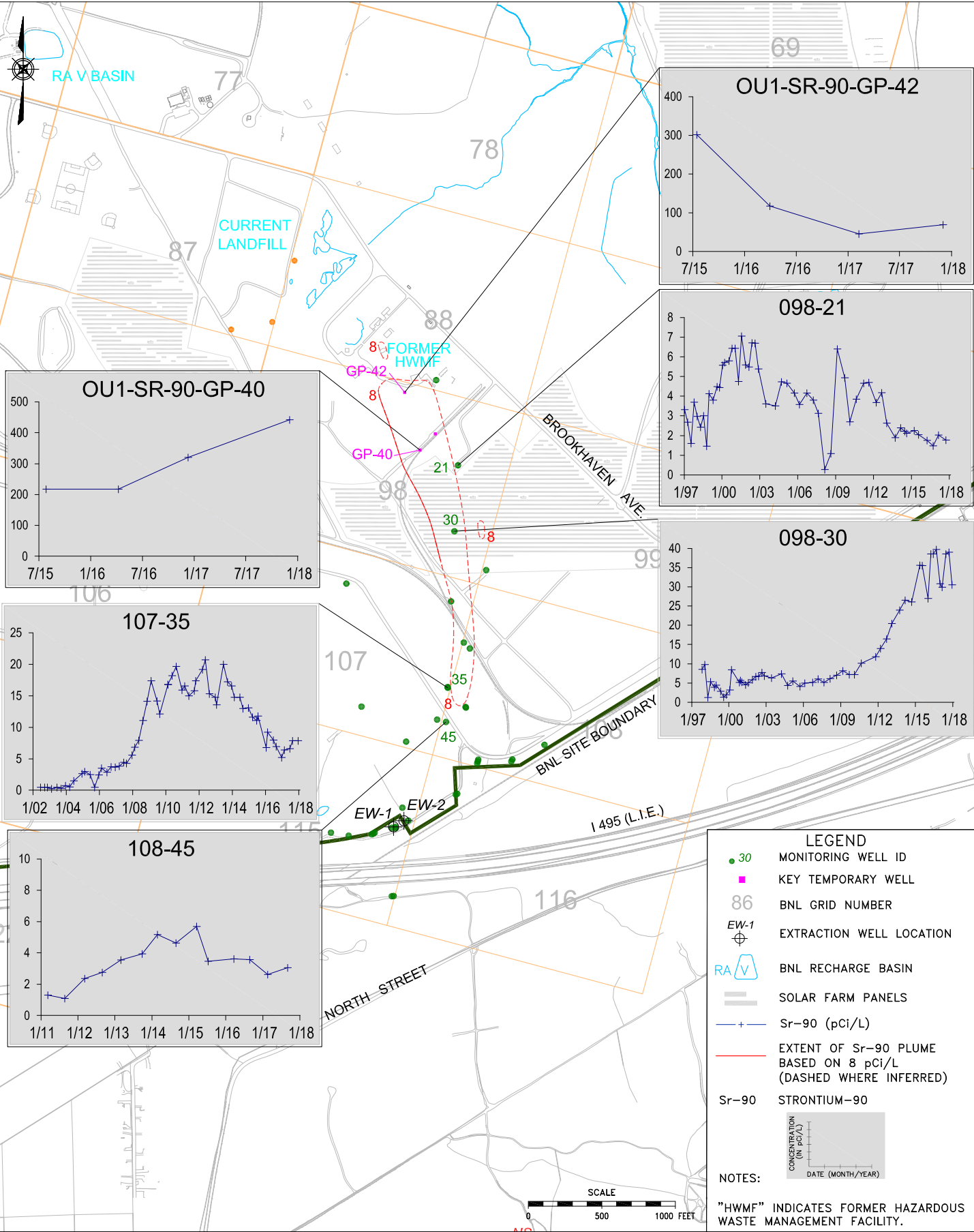

#### LEGEND

- 30 MONITORING WELL ID
- KEY TEMPORARY WELL
- 86 BNL GRID NUMBER
- EW-1 EXTRACTION WELL LOCATION
- RA BNL RECHARGE BASIN
- SOLAR FARM PANELS
- +— Sr-90 (pCi/L)
- EXTENT OF Sr-90 PLUME BASED ON 8 pCi/L (DASHED WHERE INFERRED)
- Sr-90 STRONTIUM-90

NOTES:

"HWMF" INDICATES FORMER HAZARDOUS WASTE MANAGEMENT FACILITY.

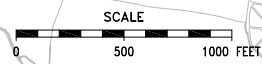

TITLE: **OU I SOUTH BOUNDARY/  
NORTH STREET EAST  
HISTORICAL Sr-90 TRENDS**  
2017 BNL GROUNDWATER STATUS REPORT

DWN: AJZ	VT:HZ.: —	DATE: 06/15/18	PROJECT NO.: —
CHKD: JEB	APPD: WRD	REV.: —	NOTES: —
FIGURE NO.:		3.1-5	