

P:\2016\BNLab\16-02 Environmental Protection Division\Task 18 2018 Annual GW Report\Report\2019-06-14\ACAD Figures\Fig_3-02-01 061419.dwg

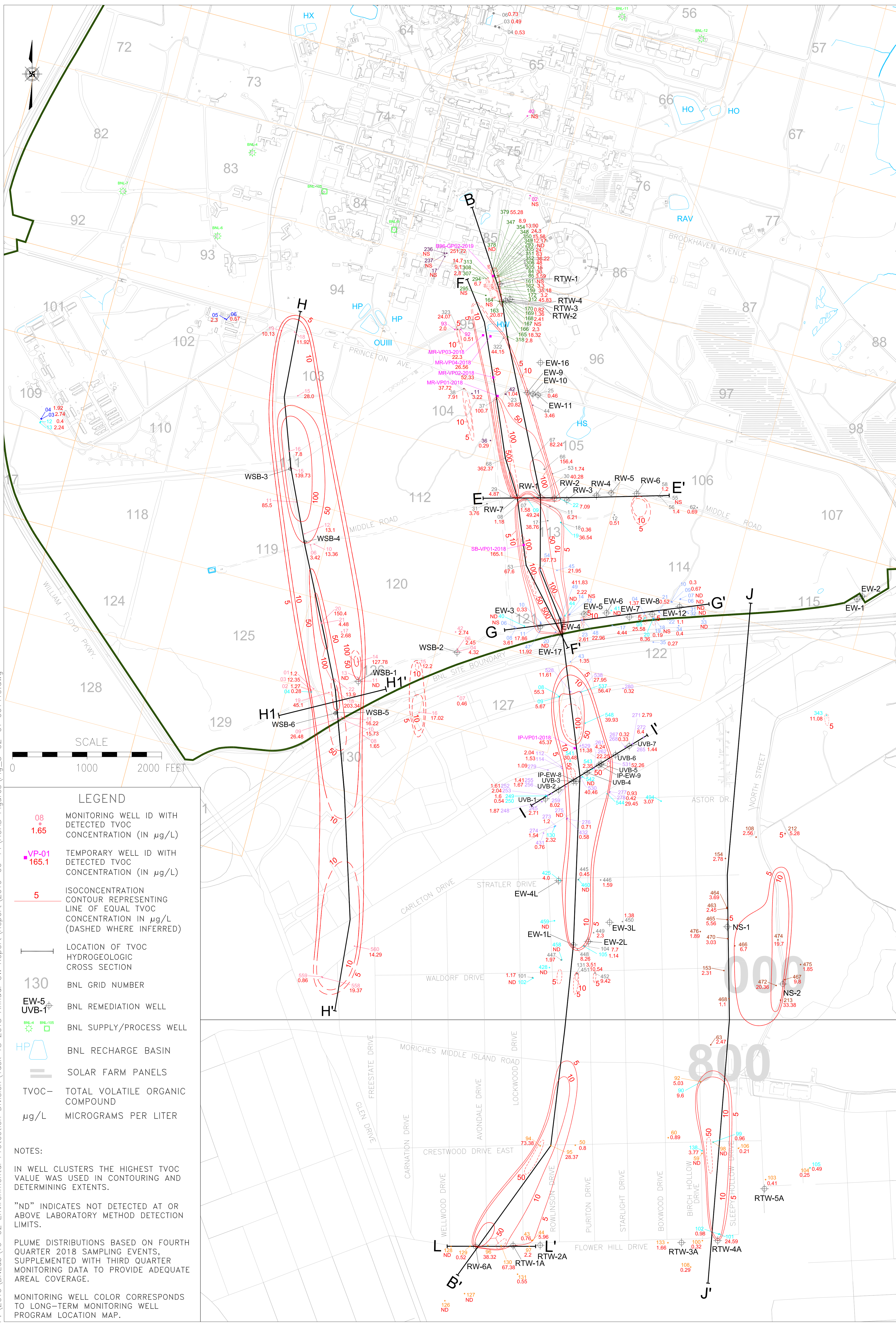

LEGEND

- 08 MONITORING WELL ID WITH DETECTED TVOC CONCENTRATION (IN µg/L)
- 1.65
- VP-01 TEMPORARY WELL ID WITH DETECTED TVOC CONCENTRATION (IN µg/L)
- 165.1
- 5 ISOCONCENTRATION CONTOUR REPRESENTING LINE OF EQUAL TVOC CONCENTRATION IN µg/L (DASHED WHERE INFERRED)
- 10
- 50
- 100
- 130 BNL GRID NUMBER
- 130 BNL REMEDIATION WELL
- EW-5
- UVB-1
- BNL-4 BNL SUPPLY/PROCESS WELL
- BNL-105
- HP BNL RECHARGE BASIN
- SOLAR FARM PANELS
- TVOC— TOTAL VOLATILE ORGANIC COMPOUND
- µg/L MICROGRAMS PER LITER

NOTES:

IN WELL CLUSTERS THE HIGHEST TVOC VALUE WAS USED IN CONTOURING AND DETERMINING EXTENTS.

"ND" INDICATES NOT DETECTED AT OR ABOVE LABORATORY METHOD DETECTION LIMITS.

PLUME DISTRIBUTIONS BASED ON FOURTH QUARTER 2018 SAMPLING EVENTS, SUPPLEMENTED WITH THIRD QUARTER MONITORING DATA TO PROVIDE ADEQUATE AREAL COVERAGE.

MONITORING WELL COLOR CORRESPONDS TO LONG-TERM MONITORING WELL PROGRAM LOCATION MAP.



TITLE: **OU III/ OU IV/ NORTH STREET TVOC PLUME DISTRIBUTIONS**

2018 BNL GROUNDWATER STATUS REPORT

DWN:	VT:HZ.:	DATE:	PROJECT NO.:
AJZ	-	06/14/19	-
CHKD:	APPD:	REV.:	NOTES:
WRD	WRD		
FIGURE NO.:		3.2-1	