

P:\2016\BNLab\16-02 Environmental Protection Division\Task 18 2018 Annual GW Report\Report\2019-06-14\ACAD Figures\Fig_3-02-10-01 061419.dwg

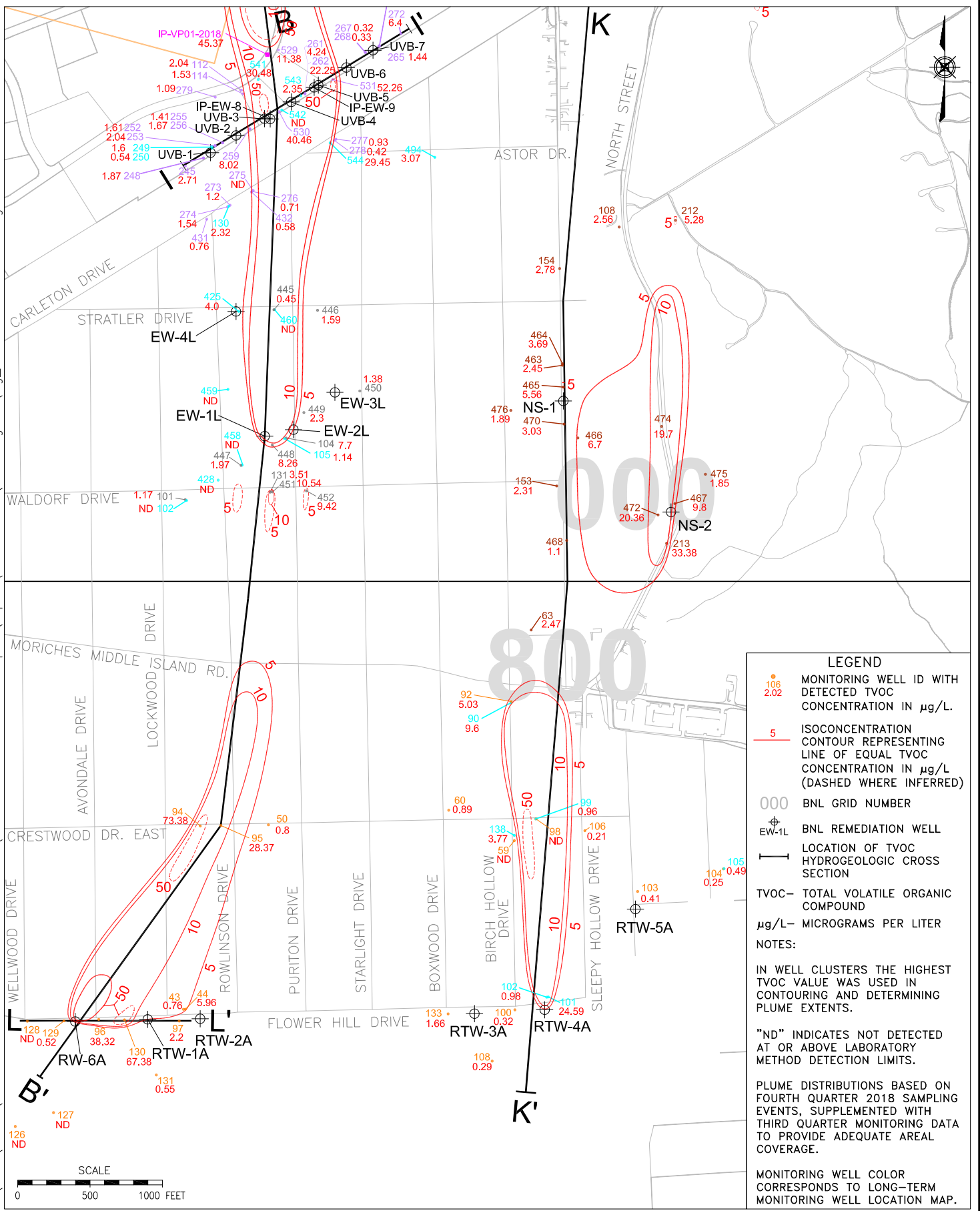

LEGEND

- 106 2.02
MONITORING WELL ID WITH DETECTED TVOC CONCENTRATION IN µg/L.
- 5
ISOCONCENTRATION CONTOUR REPRESENTING LINE OF EQUAL TVOC CONCENTRATION IN µg/L (DASHED WHERE INFERRED)
- 000
BNL GRID NUMBER
- ⊕
EW-1L
BNL REMEDIATION WELL
- LOCATION OF TVOC HYDROGEOLOGIC CROSS SECTION
- TVOC— TOTAL VOLATILE ORGANIC COMPOUND
- µg/L— MICROGRAMS PER LITER

NOTES:

IN WELL CLUSTERS THE HIGHEST TVOC VALUE WAS USED IN CONTOURING AND DETERMINING PLUME EXTENTS.

"ND" INDICATES NOT DETECTED AT OR ABOVE LABORATORY METHOD DETECTION LIMITS.

PLUME DISTRIBUTIONS BASED ON FOURTH QUARTER 2018 SAMPLING EVENTS, SUPPLEMENTED WITH THIRD QUARTER MONITORING DATA TO PROVIDE ADEQUATE AREAL COVERAGE.

MONITORING WELL COLOR CORRESPONDS TO LONG-TERM MONITORING WELL LOCATION MAP.

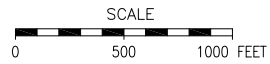

BROOKHAVEN
NATIONAL LABORATORY

ENVIRONMENTAL
PROTECTION DIVISION

TITLE:
**OU III LIPA/AIRPORT
TVOC PLUME DISTRIBUTION**

2018 BNL GROUNDWATER STATUS REPORT

DWN: AJZ	VT:HZ.: —	DATE: 06/14/19	PROJECT NO.: —
CHKD: WRD	APPD: WRD	REV.: —	NOTES: —
FIGURE NO.:		3.2.10-1	