

Hutches of SRX beamline

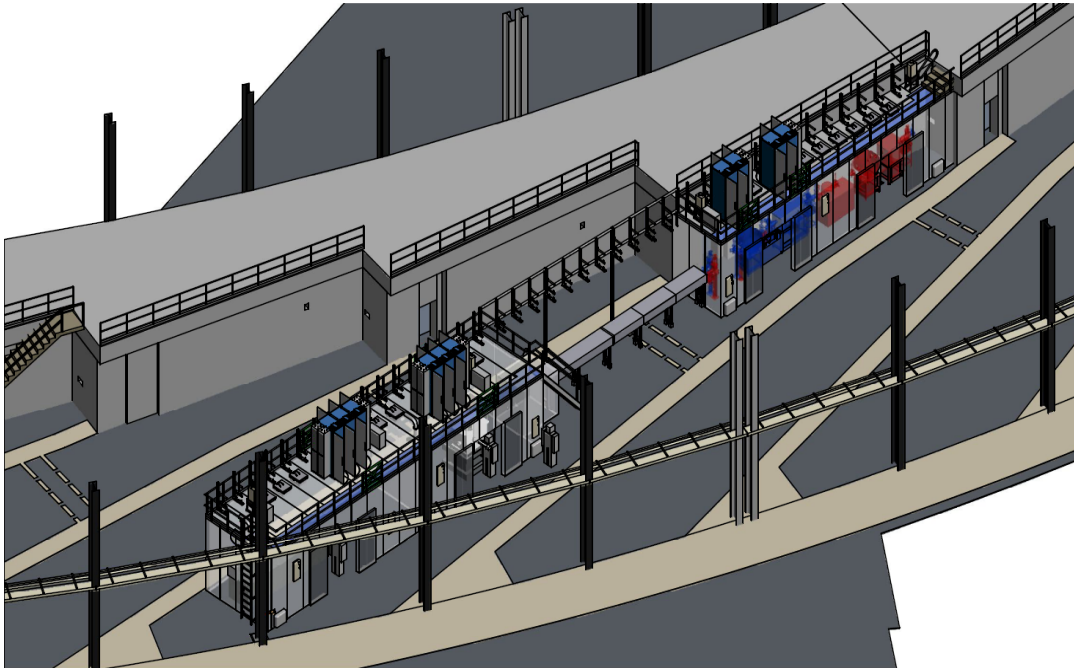

Hutch 5-ID-A (lead): Focussing mirrors, monochromators, beam defining slits for ZP branch. Beam defining slits for SRX in small steel hutch (5-ID-B). Steel hutches: Endstations for XFN (5-ID-C) and SRX (5-ID-D).

- Hutch testing completed Dec 12, 2012
- Beneficial occupancy starts Jan 14, 2013



U.S. DEPARTMENT OF
ENERGY